

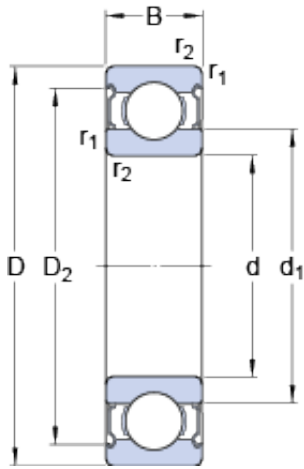

Vickers PUMP LIMITED



6312-2z Bearing 2D drawings and 3D CAD models

SKF Deep Groove Ball Bearing 6312-2z

Bearing No. 6312-2z

| | |
|-------------------------------------------|--------------------------|
| Size | 130x60x31 mm |
| Bore Diameter | 130 mm |
| Outer Diameter | 60 mm |
| Width | 31 mm |
| d | 60 mm |
| D | 130 mm |
| B | 31 mm |
| d ₁ | 81.86 mm |
| D ₂ | 112.2 mm |
| r _{1,2} - min. | 2.1 mm |
| d _a - min. | 72 mm |
| d _a - max. | 81.8 mm |
| D _a - max. | 118 mm |
| r _a - max. | 2 mm |
| Basic dynamic load rating - C | 85.2 kN |
| Basic static load rating - C ₀ | 52 kN |
| Fatigue load limit - P _u | 2.2 kN |
| Reference speed | 11000 r/min |
| Limiting speed | 5600 r/min |
| Calculation factor - k _r | 0.03 |
| Calculation factor - f ₀ | 13.1 |
| Category | Single Row Ball Bearings |
| Inventory | 0.0 |
| Manufacturer Name | SKF |
| Minimum Buy Quantity | N/A |



Vickers PUMP LIMITED

| | |
|---------------------------------|--------------------------------------------------------------------------------------------------------------------------------------------------------------------------|
| Weight / Kilogram | 1.783 |
| EAN | 7316577748751 |
| Product Group | B00308 |
| Enclosure | 2 Metal Shields |
| Precision Class | ABEC 1 ISO P0 |
| Maximum Capacity / Filling Slot | No |
| Rolling Element | Ball Bearing |
| Snap Ring | No |
| Internal Special Features | No |
| Cage Material | Steel |
| Internal Clearance | C0-Medium |
| Inch - Metric | Metric |
| Long Description | 60MM Bore; 130MM Outside Diameter; 31MM Outer Race Diameter; 2 Metal Shields; Ball Bearing; ABEC 1 ISO P0; No Filling Slot; No Snap Ring; No Internal Special Features |
| Category | Single Row Ball Bearing |
| UNSPSC | 31171504 |
| Harmonized Tariff Code | 8482.10.50.68 |
| Noun | Bearing |
| Keyword String | Ball |
| Manufacturer URL | http://www.skf.com |
| Manufacturer Item Number | 6312-2Z |
| Weight / LBS | 3.92 |
| Outside Diameter | 5.118 Inch 130 Millimeter |
| Outer Race Width | 1.22 Inch 31 Millimeter |
| Bore | 2.362 Inch 60 Millimeter |
| d ₁ | 81.86 mm |
| D ₂ | 112.2 mm |
| r _{1,2} min. | 2.1 mm |
| | |



Vickers PUMP LIMITED

| | |
|--------------------------------|---------|
| d_a min. | 72 mm |
| d_a max. | 81.8 mm |
| D_a max. | 118 mm |
| r_a max. | 2 mm |
| Basic dynamic load rating C | 85.2 kN |
| Basic static load rating C_0 | 52 kN |
| Fatigue load limit P_u | 2.2 kN |
| Calculation factor k_r | 0.03 |
| Calculation factor f_0 | 13.1 |
| Mass bearing | 1.78 kg |